

TOMAR

960-UNPK PERMANENT MOUNTING KIT **Instructions Manual**

THE
BLADETM

L O W - P R O F I L E L I G H T B A R

ISO488-00
11.29.2005

INSTALLER SAFETY MESSAGE

The safe installation of the TOMAR BLADE™ (960L) Light Bar is your first priority. All instructions listed here should be followed and common sense applied to each Light Bar installation to insure safety. TOMAR field service should be called if you have any question.

Some important precautions and instructions:

- Installers should have a good understanding of automotive electrical and mechanical systems. The quality of the installation work should equal or surpass OEM standards.
- Protect the vehicle components when drilling into the sheet metal. Metal chips and sharp edges must not be left on the vehicle. Check to see that the drill bit will not damage surrounding components when it penetrates the sheet metal.
- Review all instruction sheets packed with other components of the BLADE™ (960L) Light Bar and make sure you thoroughly understand each step of the installation before you start.
- Roof damage can occur if mounting bolts are over tightened.
- File these instructions in a safe place for future reference.

Perform a final inspection of the installation to insure that the BLADE™ (960L) Light Bar is operating properly. It should be securely fastened to the vehicle when pulling on the Light Bar mounting bracket. Failure to follow all safety procedures and instructions may result in serious injury, property damage or death to you or others.

I. GENERAL INFORMATION

This instruction sheet provides procedures to install the 960-UNPK Permanent Mounting System to the TOMAR BLADE™ (960L) Light Bar and mount the assembly to the vehicle. In order to complete the installation, you must have purchased the BLADE™ (960L) Light Bar with your specific lamp configuration and a 960-UNPK mounting kit.

II. UNPACKING

Check to see that all components shown in Figure 3 are included.

III. ASSEMBLY

- A. Turn the light bar assembly upside-down while protecting the top surface from scratches.
- B. Remove the 4 rubber bumpers from the mounting bracket feet. Loosen the mounting hardware on the mounting brackets.
- C. Cut one molded head off each of the 4 rubber bumpers as shown in Figure 1.

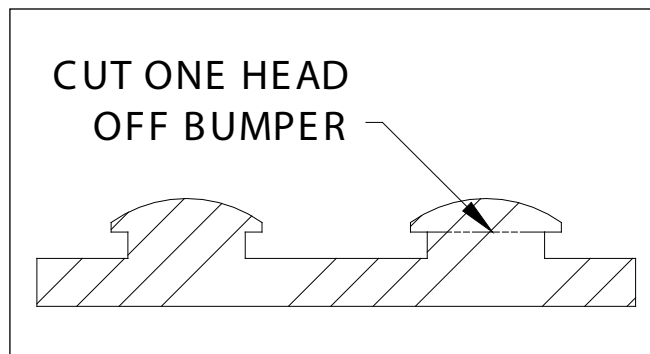

Figure 1

- D. Drill a 7/32" diameter hole through the cut head of each bumper. See Figure 2.

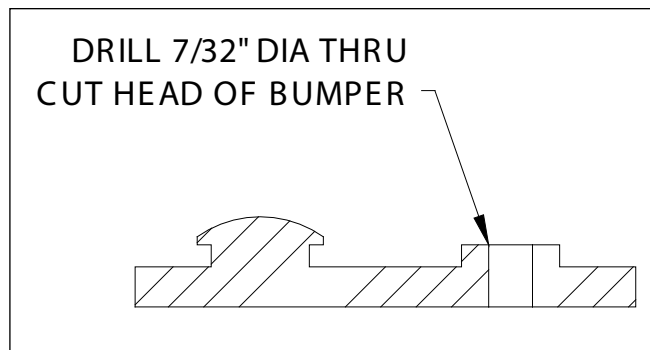

Figure 2

- E. Center the light bar on the vehicle roof, approximately over the driver's head. Adjust both mounting bracket assemblies so that the bracket feet rest near the edge of the roof or gutter where the roof is most rigid. Check to see that the light bar is still centered and the mounting brackets are equally spaced on each side of the vehicle. Tighten the four 5/16" screws on each bracket to hold the brackets in position on the light bar.
- F. Using the holes in the mounting bracket feet as a guide, scribe 2 drill position marks for each bracket. Make sure the drill positions are located at the outboard (front and rear) hole positions on the mounting bracket feet.
- G. Move the light bar out of the way. Drill four 9/16" diameter holes at the scribed drill marks.
CAUTION: Make sure that holes are only drilled through the sheet metal, NOT through upholstery or wiring.
- H. Insert a toggle bolt in each of the four holes and slide a rubber bumper over each toggle bolt to hold it in place.
- J. Remove the light bar from the roof and lay it upside-down on a protected work surface. Cut the two whistle strip extrusions to the correct lengths. Press them into the mounting slots on the bottom of the main aluminum extrusion. NOTE: This is very important in order to reduce wind noise at high speeds.
- K. Reposition the light bar on the roof of the vehicle over each of the previously installed toggle bolts. Press the rubber bumpers into the mounting bracket feet.
- L. Install one 1/4-20 flat washer and two 1/4-20 jam nuts on the toggle bolt at each cut head on the rubber bumpers. Tighten lower jam nut to snug condition: no visible play of mount foot or rubber bumper. Lock lower jam nut with upper jam nut. NOTE: Two (2) jam nuts must be used in a double nut configuration on each toggle bolt to ensure safe installation of the light bar. See Figures 3 and 4.
- M. Saw off the toggle bolts above the jam nuts. See Figure 4. NOTE: It may be necessary to use cardboard or some other material to protect the bracket while sawing off the toggle bolts.
- N. Inspect the entire assembly to insure that all fasteners and brackets are tight.

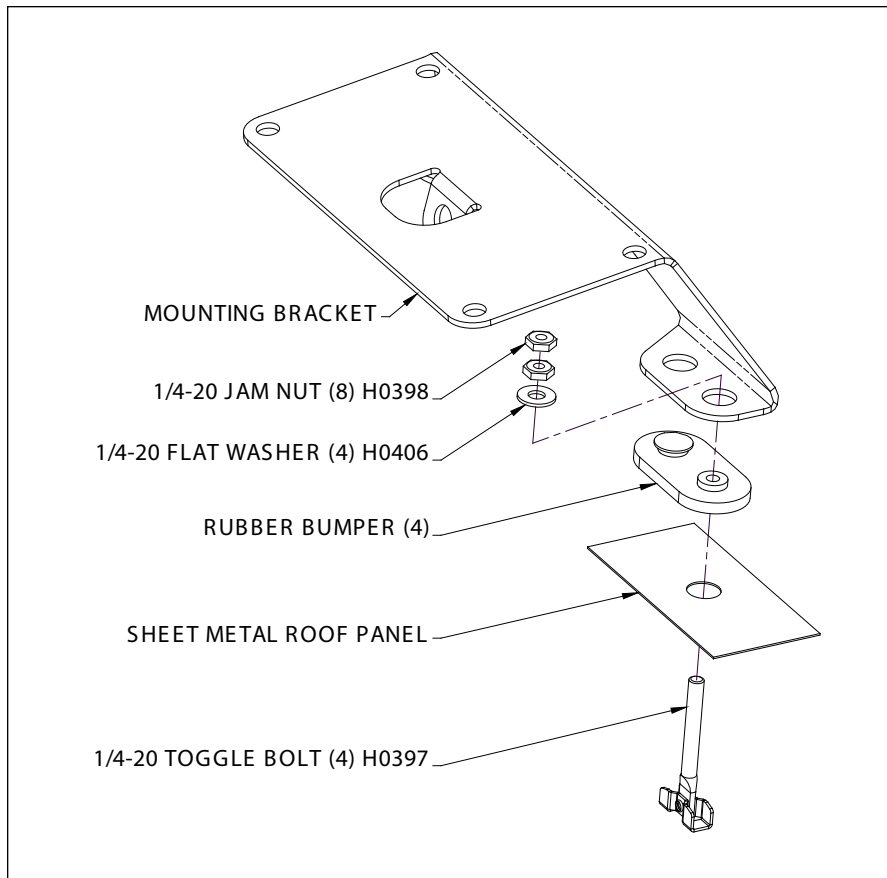

Figure 3

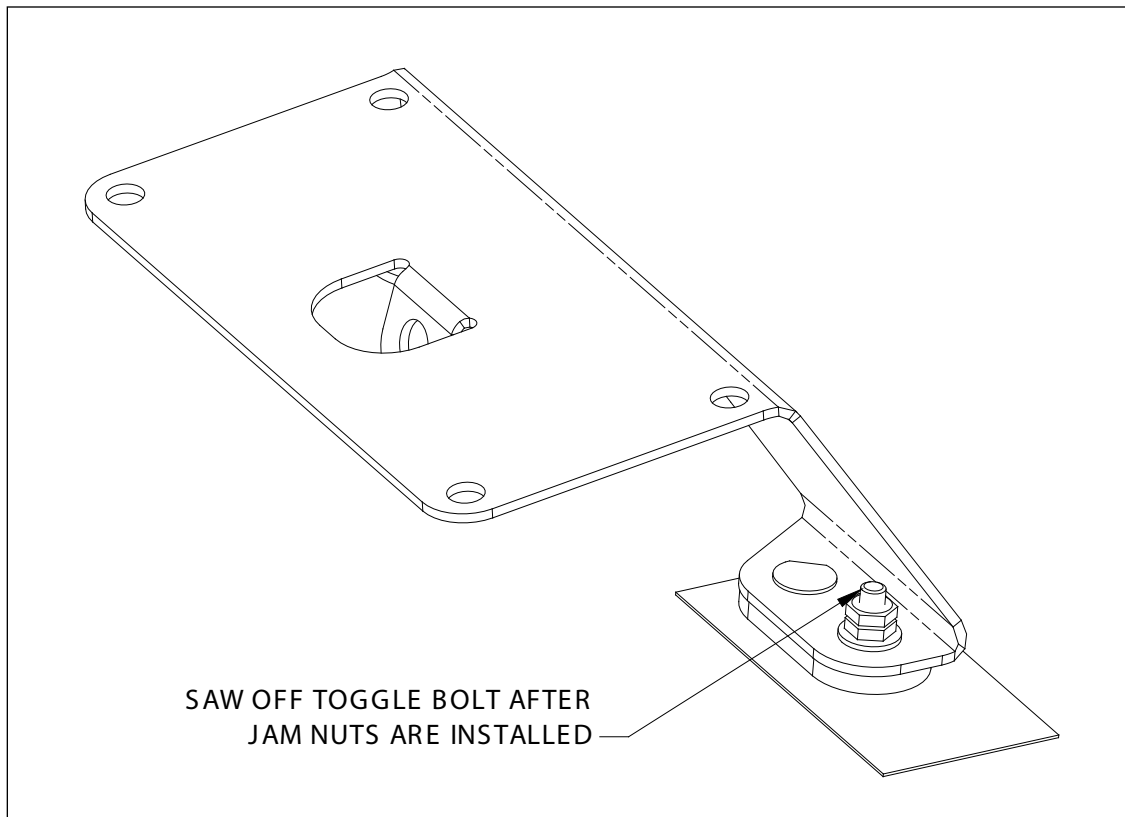

Figure 4

Assembled View

TOMAR Electronics, Inc.
2100 W. Obispo Ave.
Gilbert, AZ 85233 USA

800.338.3133 ph
800.688.6627 fax

www.tomar.com